

L BUTT CONNECTORS

中间套管

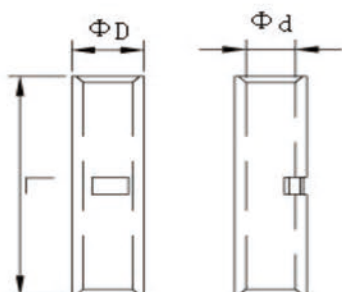

PART NO 2015-2018	ITEM NO	DIMENSIONS		
		ΦD	Φd	L
LY0017-0001	L1.5	3.7	1.8	20.0
LY0017-0002	L2.5	4.0	2.4	20.0
LY0017-0003	L4	4.8	3.1	20.0
LY0017-0004	L6	5.5	3.8	20.0
LY0017-0005	L10	6.2	4.5	20.0
LY0017-0006	L16	7.1	5.4	40.0
LY0017-0007	L25	8.8	6.8	45.0
LY0017-0008	L35	10.6	8.2	45.0
LY0017-0009	L50	12.4	9.5	45.0
LY0017-0010	L70	14.7	11.2	50.0
LY0017-0011	L95	17.4	13.5	50.0
LY0017-0012	L120	19.4	15.0	55.0
LY0017-0013	L150	21.2	16.5	60.0
LY0017-0014	L185	23.5	18.5	65.0
LY0017-0015	L240	26.5	21.0	80.0
LY0017-0016	L300	30.0	23.5	85.0
LY0017-0017	L400	36.5	28.5	90.0
LY0017-0018	L500	39.0	30.0	100.0
LY0017-0019	L550	41.4	31.7	100.0
LY0017-0020	L630	45.0	35.0	110.0
LY0017-0021	L800	50.6	39.0	150.0
LY0017-0022	L1000	56.2	43.0	170.0
LY0017-0023	A-L1.5	3.6	1.8	20.0
LY0017-0024	A-L2.5	3.9	2.4	20.0
LY0017-0025	A-L4	4.7	3.1	20.0
LY0017-0026	A-L6	5.4	3.8	20.0
LY0017-0027	A-L10	6.1	4.5	20.0
LY0017-0028	A-L16	7.0	5.4	40.0
LY0017-0029	A-L25	8.6	6.8	45.0
LY0017-0030	A-L35	10.4	8.2	45.0
LY0017-0031	A-L50	12.2	9.5	45.0
LY0017-0032	A-L70	14.4	11.2	50.0
LY0017-0033	A-L95	17.1	13.2	50.0
LY0017-0034	A-L120	19.0	15.0	55.0
LY0017-0035	A-L150	20.8	16.5	60.0
LY0017-0036	A-L185	23.1	18.5	65.0
LY0017-0037	A-L240	26.0	21.0	80.0
LY0017-0038	A-L300	29.4	23.5	85.0
LY0017-0039	A-L400	35.8	28.5	90.0
LY0017-0040	A-L500	38.2	30.0	100.0
LY0017-0041	A-L630	44.1	35.0	110.0